



# TIWI ISLAND RETREAT

## Welcome

Escape to a remote, natural paradise where you're completely off the grid and anything is possible. Set amongst a pristine marine sanctuary, Tiwi Island Retreat is one of Australia's premier barefoot destinations, hidden away on the western edge of Bathurst Island, Tiwi Islands.

Tiwi Island Retreat is a place for everyone. Simply relax and enjoy the exclusive beachfront location, try your hand at our world class fishing adventures, participate in Indigenous cultural tours, or simply take in the surrounding pristine paradise from our 12 metre beachfront pool.

The Retreat features Luxury Glamping Tents and a range of coastal-style twin and family share rooms. Our resident chef serves the most incredible ocean to plate cuisine, from chilli mud crab, barramundi wings and sashimi.

Our room rate is an inclusive package designed to offer you the very best of the island life. You have the option to customise your stay by booking any of our scenic, fishing, helicopter or cultural tours listed in our activity menu.

Tiwi Island Retreat acknowledges and pays respect to the past, present, and future Traditional Custodians and Elders of this nation; we are proud to work closely with the traditional owners of the Tiwi Islands to honour their land and culture in everything we do.

*See you soon*

## Contact us today

(08) 7937 1707

stay@tiwiislandretreat.com.au

Port Hurd, Bathurst Island NT 0822



We offer a minimum 2-night stay at Tiwi Island Retreat, with pricing starting **from \$1,320** per room, per night.

## Pricing Inclusions

- » Beautifully appointed accommodation
- » Menu designed by award winning chef
- » Ocean to plate and locally sourced produce
- » Daily sunset canapes and cocktails
- » Select alcohol - beer, wine and spirits
- » Tiwi Island Retreat welcome pack
- » Beach buggy ride and bonfire with canapes
- » Beach fishing
- » Tiwi Island visitor and fishing permits
- » Estuary boat adventure
- » Boat transfers between Port Hurd airstrip & the Retreat

## Pricing Exclusions

- » Transfers from Darwin to Tiwi Island Retreat. Contact our Reservations team or see the end of this brochure for options.
- » Additional activities. [Click here](#) to view our activity menu.

Enhance your stay at Tiwi by booking one of our additional experiences. We recommend pre-booking your activities prior to arrival at the Retreat due to limited availability.

## Activity Menu

- » **Private Beach Dining & Buggy Tour | \$180 pp**  
*1.5 hours. Minimum 2 guests.*
- » **Estuary Fishing | \$300 pp**  
*3.5 hours. Minimum 2 guests, maximum 4 guests.*
- » **Tiwi by Design Cultural Tour | \$310 pp**  
*Full day. Minimum 4 guests. Available Mon - Fri, Jun to Oct only.*
- » **Blue Water Fishing | \$495 pp**  
*Half Day / 4 hours. Minimum 4 guests, maximum 12 guests.*
- » **Helicopter Scenic Flight & Ranku Swimming Hole Tour | \$595 pp**  
*1.5 hours. Minimum 2 guests*
- » **Tiwi Helifishing Adventure | \$1,225 pp**  
*3 hours. Minimum 2 guests, maximum 3-6 guests.*
- » **Exclusive Jilamara Fine Art Experience | \$2,540 for 2 guests**  
*2.5 hours. \$770 per additional guest. Minimum 2 guests, maximum 3-6 guests. Available Mon - Fri only.*

2-Night Inclusive Room Rate	Bedding Configurations	Twin Share	Family (2A+2C)	Extra Adult	Extra Child
<b>Village Rooms</b> , shared amenities <i>Perfect for group bookings</i> (8 rooms)	Queen or king single Queen & 1 bunk	\$2,640	\$3,080	\$1,100	\$660
<b>Ocean Rooms</b> , ensuited <i>Maximum 2 guests</i> (10 rooms)	Queen	\$3,300	NA	NA	NA
<b>Family Ocean Room</b> , ensuited <i>Maximum 6 guests</i> (1 room)	King Single bunk Double sofa	\$4,400	\$4,620	\$1,100	\$660
<b>Luxury Glamping Tents</b> , ensuited <i>Maximum 5 guests</i> (2 tents)	King Bunk, single top Double bottom	\$4,840	\$5,280	\$1,100	\$660

3-Night Inclusive Room Rate	Bedding Configurations	Twin Share	Family (2A+2C)	Extra Adult	Extra Child
<b>Village Rooms</b> , shared amenities <i>Perfect for group bookings</i> (8 rooms)	Queen or king single Queen & 1 bunk	\$3,960	\$4,620	\$1,650	\$990
<b>Ocean Rooms</b> , ensuited <i>Maximum 2 guests</i> (10 rooms)	Queen	\$4,950	NA	NA	NA
<b>Family Ocean Room</b> , ensuited <i>Maximum 6 guests</i> (1 room)	King Single bunk Double sofa	\$6,600	\$6,930	\$1,650	\$990
<b>Luxury Glamping Tents</b> , ensuited <i>Maximum 5 guests</i> (2 tents)	King Bunk, single top Double bottom	\$7,260	\$7,920	\$1,650	\$990

**Contact us today**  
 (08) 7937 1707  
 stay@tiwiislandretreat.com.au  
 Port Hurd, Bathurst Island NT 0822



4-Night Inclusive Room Rate	Bedding Configurations	Twin Share	Family (2A+2C)	Extra Adult	Extra Child
<b>Village Rooms</b> , shared amenities <i>Perfect for group bookings</i> (8 rooms)	Queen or king single Queen & 1 bunk	\$5,280	\$6,160	\$2,200	\$1,320
<b>Ocean Rooms</b> , ensuited <i>Maximum 2 guests</i> (10 rooms)	Queen	\$6,600	NA	NA	NA
<b>Family Ocean Room</b> , ensuited <i>Maximum 6 guests</i> (1 room)	King Single bunk Double sofa	\$8,800	\$9,240	\$2,200	\$1,320
<b>Luxury Glamping Tents</b> , ensuited <i>Maximum 5 guests</i> (2 tents)	King Bunk, single top Double bottom	\$9,680	\$10,560	\$2,200	\$1,320

### Additional Information

**Meals include:** Breakfast, lunch, dinner and canapes.

**What to bring:** Hat, bathers, camera, a small soft bag packed with light clothing (approx 7-10kg pp).

**Additional bedding:** Porta cots available on request.

**Alcohol:** Strictly no BYO alcohol.

**Transfers:** Tiwi Island Retreat is located on the coast of Port Hurd, Bathurst Island. There are a number of transfer options to the Retreat. Please contact our Reservations team to find out more, or see transfer options in the brochure below.



\*Map is indicative only

### Terms & Conditions

#### Bookings with 7 rooms or less

##### Payment Terms

30% deposit at time of booking - non refundable  
Full payment 60 days prior to arrival  
Full payment if booking is made within 60 days of arrival

##### Cancellation

60 days or after – loss of deposit  
60 days or less prior to arrival is loss of all monies

#### Corporate/large booking - 8 rooms or more

##### Payment Terms

30% deposit at time of booking - non refundable  
Further 20% deposit 90 days out  
Full payment 60 days prior to arrival  
Full payment if booking is made within 60 days of arrival

##### Cancellation

90 days or after – is loss of 30% deposit  
60-90 days – loss of 50% deposit  
60 days or less prior to arrival is loss of all monies

To view full Terms & Conditions, please [click here](#).

Tiwi Island Retreat  
Main Hub

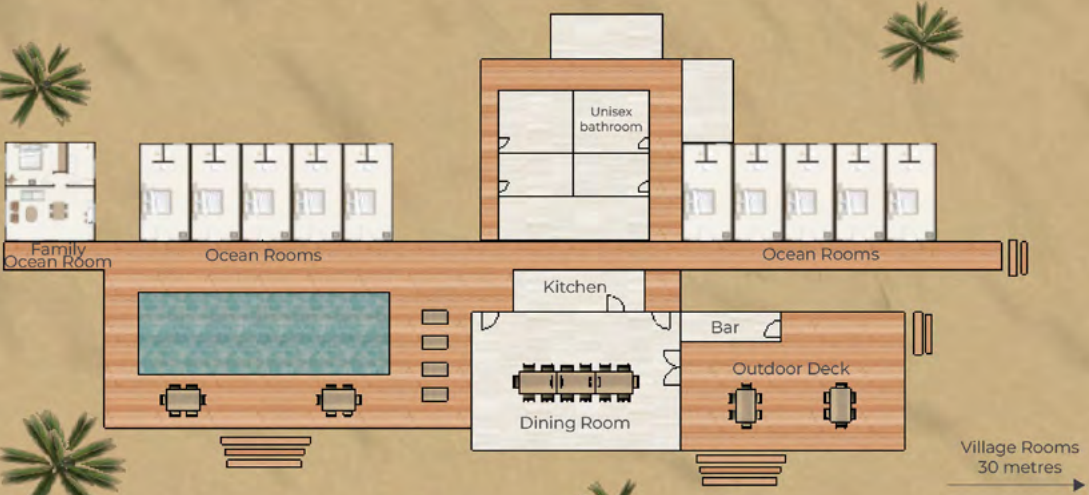

Plan is indicative only

Village Room  
Quarters

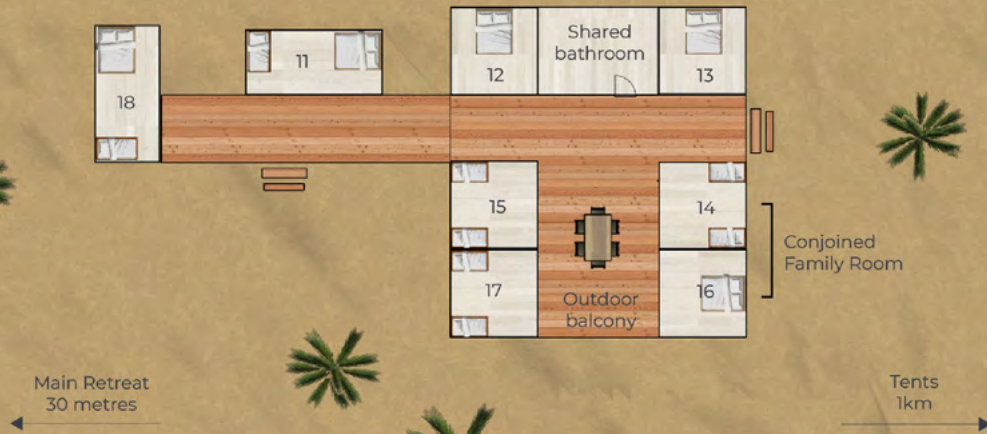

Plan is indicative only

Contact us today  
 (08) 7937 1707  
 stay@tiwiislandretreat.com.au  
 Port Hurd, Bathurst Island NT 0822







	Air Frontier Scenic Flight	Fly Tiwi Scenic Flight	SeaLink NT Ferry
Journey details	Take a 30-minute scenic flight from Darwin over the Beagle Gulf, where breathtaking Tiwi Island coastal views will reveal itself just a short while into your journey. Land at Port Hurd airstrip where you will be picked up by boat for a 15-minute transfer to Tiwi Island Retreat.	Jump on a 30-minute scenic flight from Darwin and experience a birds-eye view of the Tiwi Islands. Arrive at Wurrumiyanga Airport and meet one of our friendly tour guides where you'll set off via car on a 1.5 hour dirt road adventure. Stop at Port Hurd airstrip and take a 15-minute boat ride to Tiwi Island Retreat. To add the Tiwi By Design cultural tour on your arrival / departure, speak to our Reservations team.	Travel via SeaLink ferry for a 2.5 hour journey to Wurrumiyanga, the cultural epicentre of the Tiwi Islands. Meet one of our friendly tour guides at the ferry terminal and hop into the Tiwi Island Retreat car, where you'll set off on a 1.5 hour dirt road adventure. Stop at Port Hurd airstrip and be taken on a 15-minute journey via boat to Tiwi Island Retreat. To add the Tiwi By Design cultural tour on your arrival / departure, speak to our Reservations team.
Operation	Operates on demand, daily.	Available 1 June to 15 October (please confirm availability with our Reservations team). Operates daily from Darwin to Wurrumiyanga. Pick ups by Tiwi Island Retreat via car from Wurrumiyanga airport are also offered daily, subject to block out dates at the Retreat.	Available 1 June to 15 October (please confirm availability with our Reservations team). Operates on Thursday, Friday, Sunday. During the dry season from June to August, this service also operates on Monday (Exemptions: 12 June 2023 and 7 August 2023).
Route	Darwin to Port Hurd Port Hurd to Darwin	Darwin to Wurrumiyanga Wurrumiyanga to Darwin	Darwin to Wurrumiyanga Wurrumiyanga to Darwin
Price	From \$375 per person return*   Infant FOC	Adult \$195   Child \$140.00   Infant FOC	Adult \$60   Concession \$45   Child \$30   Family of 5 \$160   Infant FOC
Departure time	Darwin to Port Hurd: 1030 Port Hurd to Darwin: 1130 Check-in 30 minutes prior to departure	Darwin to Wurrumiyanga: 1200 Wurrumiyanga to Darwin: 1250 Check-in 45-60 minutes prior to departure	Darwin to Wurrumiyanga: 0800 (Mon, Thu, Fri), or 1015 (Sun) Wurrumiyanga to Darwin: 1515 (Mon, Thu, Fri), or 1415 (Sun) Check-in 30 minutes prior to departure
Travel time	Flight: 30 minutes Boat transfer: 15 minutes	Flight: 30 minutes Car transfer: 90 minutes	Ferry: 2.5 hours Car transfer: 90 minutes
Bookings	Flights are booked by our Reservations team. Payment is made directly to Air Frontier upon check in for your flight.	Flights are booked by our Reservations team and payment is to be made directly to Tiwi Island Retreat.	Ferry is booked by our Reservations Team and payment is to be made directly to Tiwi Island Retreat.
Carrier details	7 Murphy Drive, Eaton NT 0812 General Aviation area of Darwin Airport (08) 8945 0777   admin@airfrontier.com.au	7 Murphy Road, Eaton NT 0812 General Aviation area of Darwin Airport (08) 8928 9300   operations@flytiwi.com.au	5/57 Marina Boulevard, Larrakeyah NT 0820 1300 130 679
Terms & Conditions	<a href="#">Air Frontier Terms &amp; Conditions</a>	<a href="#">Fly Tiwi Terms &amp; Conditions</a>	<a href="#">SeaLink Terms &amp; Conditions</a>
Alternative transfer options	If you wish to arrive in style, other transfer options include arriving via Paspaley Mallard (flying boat) or helicopter, please contact our Reservations team at <a href="mailto:stay@tiwiislandretreat.com.au">stay@tiwiislandretreat.com.au</a> or 08 7937 1707. If you wish to drive your own boat or fly your own aircraft to Port Hurd airstrip, please contact our Reservations team at <a href="mailto:stay@tiwiislandretreat.com.au">stay@tiwiislandretreat.com.au</a> or 08 7937 1707.		

\*This cost is indicative only and is based on all seats being occupied on an Air Frontier plane both ways. A Cesna C210 fits max 4pax and a Piper Chieftan fits max 9pax. For a quote, please contact our Reservations team.

Disclaimer: All third-party carriers are subject to their own Terms & Conditions. Any funds paid to Tiwi Island Retreat for your transfers are considered as part of your booking total and our standard cancellation policy will apply. To view our cancellation policy, view our [Terms & Conditions here](#).

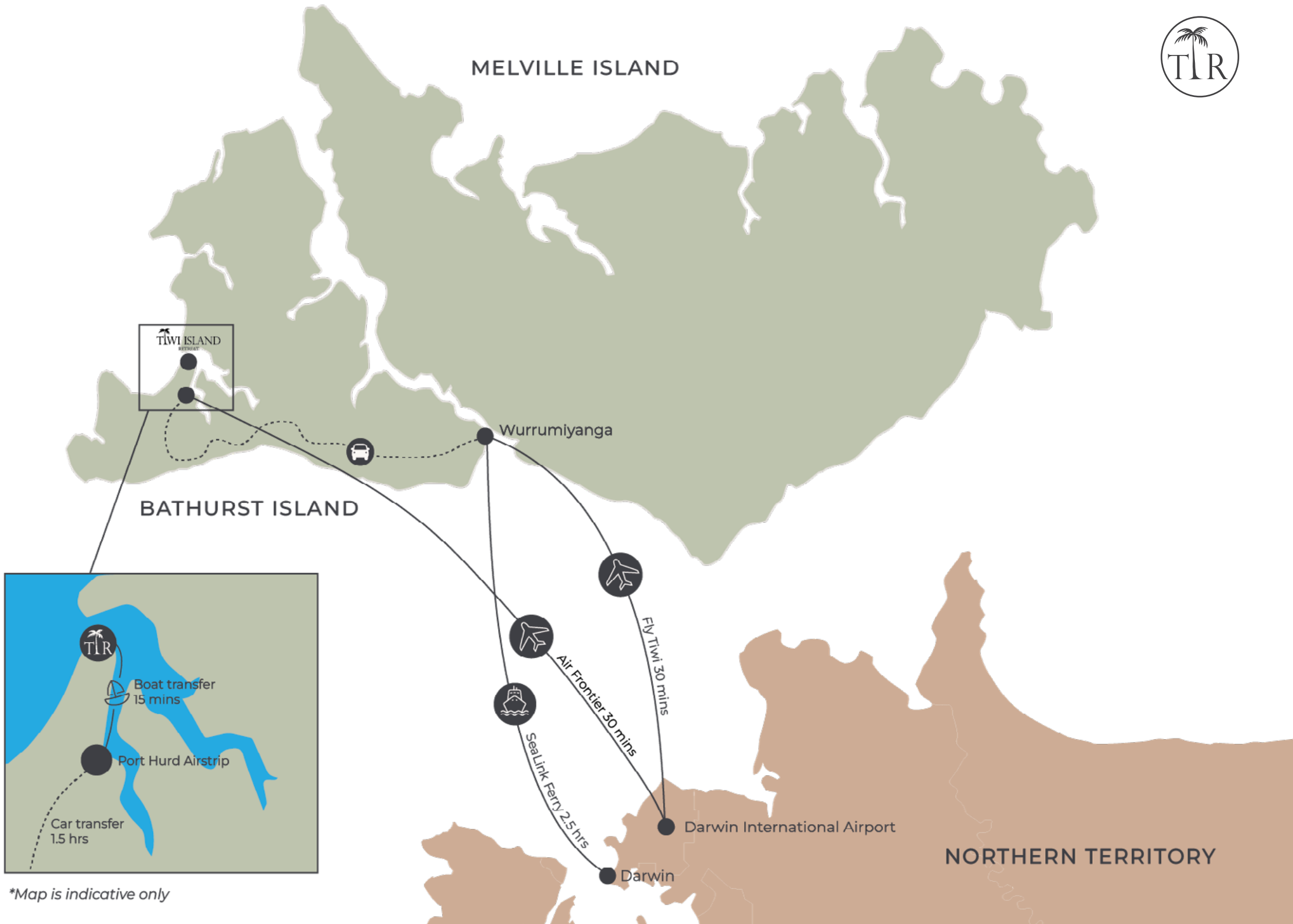

\*Map is indicative only